

PROJECT SUMMARY
 TOTAL AREA: ± 25.8 AC (GROSS)
 RESIDENTIAL AREA: ± 16.6 AC (GROSS)
 COMMUNITY SERVING USES: ± 9.2 AC

- NUMBER OF HOMES: 109 UNITS (+40 to 55 ADUs)
- COTTAGE (27 UNITS)
 - UPDATED (3) & NEW (2) RANCH STYLE RESIDENCES (5 UNITS)
 - HALF-PLEX TOWNHOME (22 UNITS)
 - FIRST MOVE-UP SFR (29 UNITS + 20 ADUs)
 - SECOND MOVE-UP SFR (MID-LEVEL) (26 UNITS + 20 ADUs)

LEGEND			
UNIT TYPE	UNITS (ADU)	DENSITY (UNITS/AC)	
		GROSS	NET
COTTAGE A	15	14.6	20.0
COTTAGE B	8	14.8	21.6
COTTAGE C	4	8.2	15.2
RANCH STYLE	5	2.9	3.9
HALF-PLEX	22	10.1	12.6
FIRST MOVE-UP	29 (20)	5.4 (9.1)	7.7 (13.0)
SECOND MOVE-UP (MID-LEVEL)	26 (20)	4.9 (8.7)	7.3 (12.9)

*DENSITY CALCULATIONS ARE BASED ON RESIDENTIAL AREA OF THE PROPOSED DEVELOPMENT

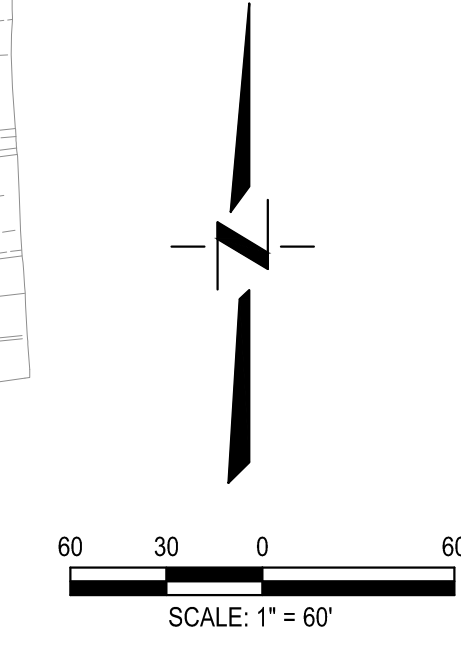

DESIGNED BY: BF DRAWN BY: NC CHECKED BY: BF	<h2 style="margin: 0;">PALOMINO PLACE</h2> <h3 style="margin: 0;">CONCEPTUAL SITE PLAN</h3>	 Project Planning • Civil Engineering • Landscape Architecture	CECWEST.COM Sacramento Office: 2120 20th Street, Suite Three, Sacramento, CA 95816 (916) 455-2026 Davis Office: 2940 Spafford Street, Suite 200, Davis, CA 95618 (530) 758-2026	<table border="1" style="width: 100%; border-collapse: collapse;"> <thead> <tr> <th>NO.</th> <th>DATE</th> <th>REVISIONS</th> <th>BY</th> <th>APPD.</th> </tr> </thead> <tbody> <tr><td> </td><td> </td><td> </td><td> </td><td> </td></tr> <tr><td> </td><td> </td><td> </td><td> </td><td> </td></tr> <tr><td> </td><td> </td><td> </td><td> </td><td> </td></tr> </tbody> </table>	NO.	DATE	REVISIONS	BY	APPD.																SHEET <h1 style="margin: 0;">1</h1> OF <h1 style="margin: 0;">1</h1> DATE: 09/16/21 PROJECT NO: 1807.01
NO.	DATE	REVISIONS	BY	APPD.																					
DAVIS		CALIFORNIA																							

S:\Projects\1807\1807-Palomino-Place\AutoCAD\1807-01-LOT-CARAVAGGIO-DRIVE-CONCEPTUAL-SITE-PLAN.dwg - Layout - 9/16/2021 - 9:58AM Plotted by: Brian